

This drawing should not be scaled. Dimensions to be verified on site.
Any discrepancies should be referred to the Engineer prior to work being put in hand.
This drawing is the property of Waterman Moylan Consulting Engineers Limited and is
issued on the condition that it is not copied, reproduced, retained or disclosed to any unauthorized person, either
wholly or in part without the consent in writing of
Waterman Moylan Consulting Engineers Limited
Block S East Point Business Park, Dublin D03 H3F4 Ireland +353 1 664 8900

- NOTES:
- DO NOT SCALE. USE FIGURED DIMENSIONS ONLY.
 - THIS DRAWING IS TO BE READ IN CONJUNCTION WITH ALL OTHER RELEVANT ARCHITECTURAL AND ENGINEERING DRAWINGS.

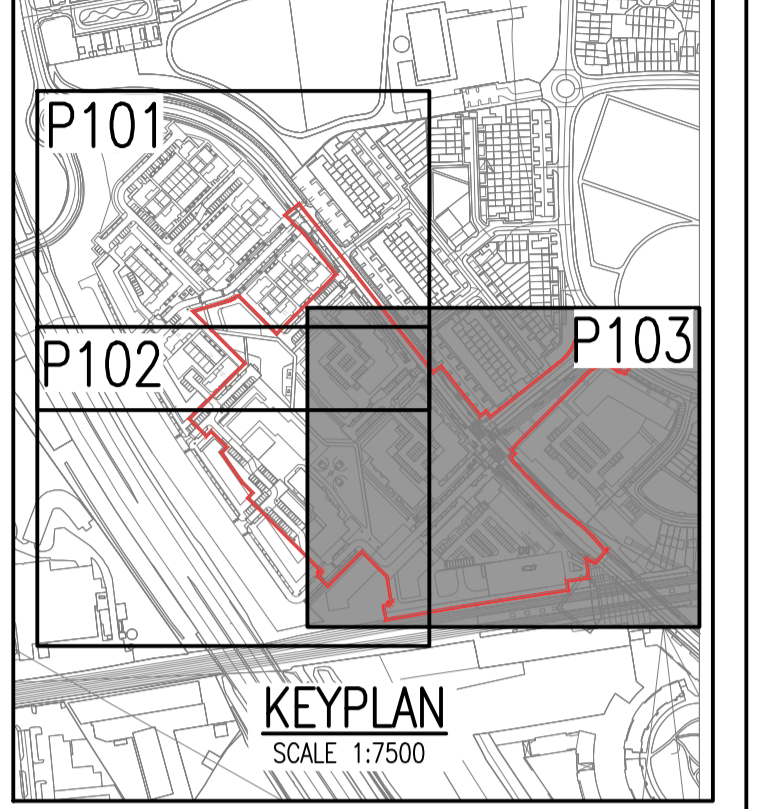

LEGEND

| | |
|-------|--|
| | PROPOSED PLANNING APPLICATION BOUNDARY |
| | PROPOSED ROAD CHAINAGE |
| 56.52 | PROPOSED ROAD LEVEL |
| FFL | PROPOSED FINISHED FLOOR LEVEL |

INDICATIVE MASTERPLAN LAYOUT ONLY
SUBJECT TO SEPARATE FUTURE PLANNING APPLICATION

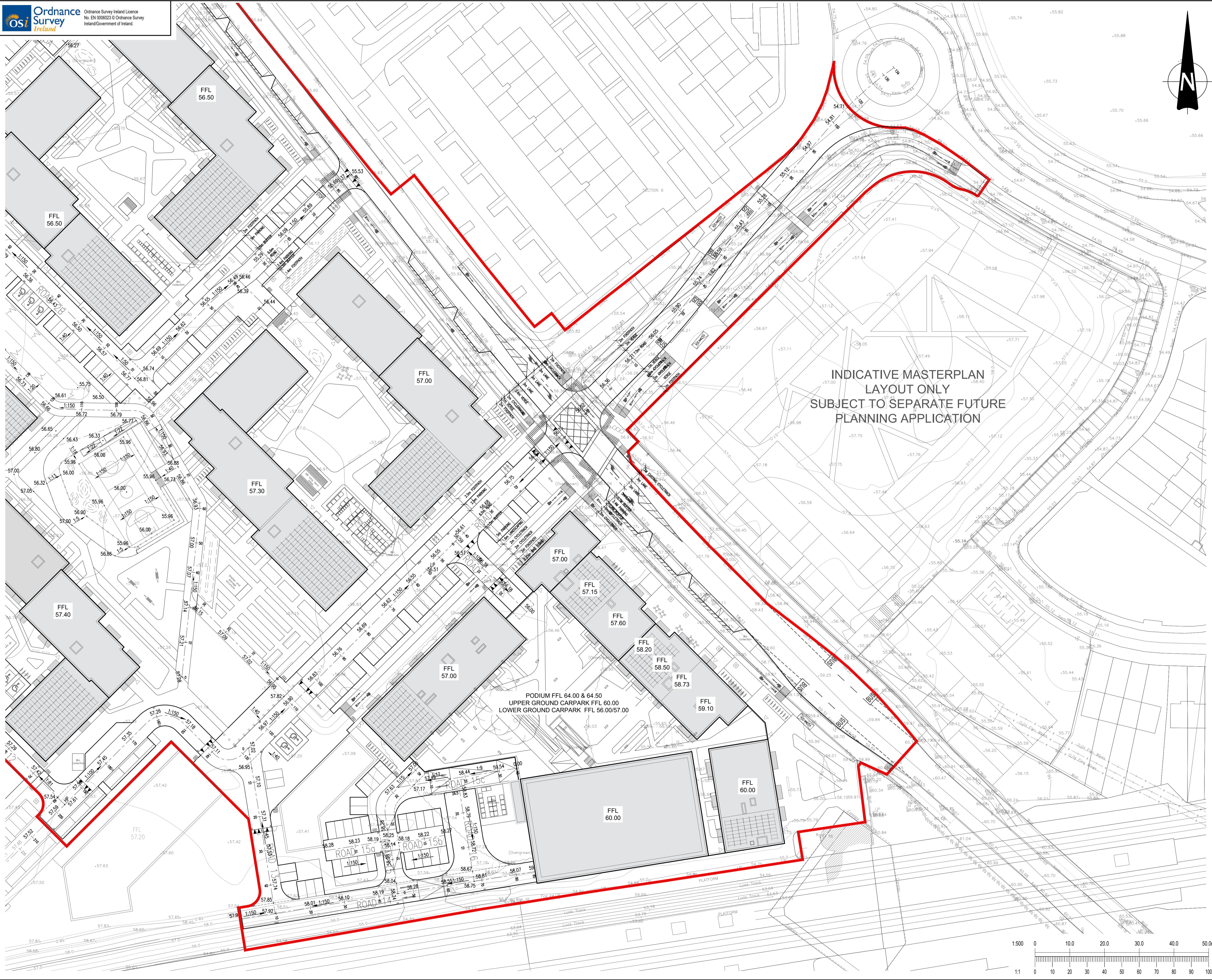

PODIUM FFL 64.00 & 64.50
UPPER GROUND CARPARK FFL 60.00
LOWER GROUND CARPARK FFL 56.00/57.00

| Rev | Date | Description | By | Chk |
|------------|------|-------------|----|-----|
| Amendments | | | | |

Project: **CHERRY ORCHARD POINT**

Title: **ROAD LAYOUT SHEET 3 OF 3**

Client: **LAND DEVELOPMENT AGENCY**



BLOCK S, EASTPOINT BUSINESS PARK, ALFIE BYRNE ROAD,
DUBLIN D03 H3F4 IRELAND. Tel: (01) 664 8900
Email: info@waterman-moylan.ie www.waterman-moylan.ie

Status: **PLANNING**

| | | | | | |
|-------------|-----|----------|----------|--------------|--------|
| Designed By | PJD | Approved | IW | Waterman Ref | 22-010 |
| Drawn By | PJD | Date | OCT 2023 | Scales @ A1 | 1:500 |

| | | | | | | | |
|---------|------------|--------|-------|------|------|--------|--------------------------|
| Project | Originator | Volume | Level | Type | Role | Number | Revision |
| | | | | | | | COP-WMC-PH1-00-DR-C-P103 |

